

Contents

Vehicle Details.....	2
Compatible Compressors	3
Compressor Kit Configurations	3
Parts View	4
Installation Precautions	5
Pre Installation	6
Crankshaft Pulley Installation.....	6
Mount Bracket Installation	7
Compressor Modification.....	7
Compressor Installation	7
Post-Installation	8
Drive Belt.....	8

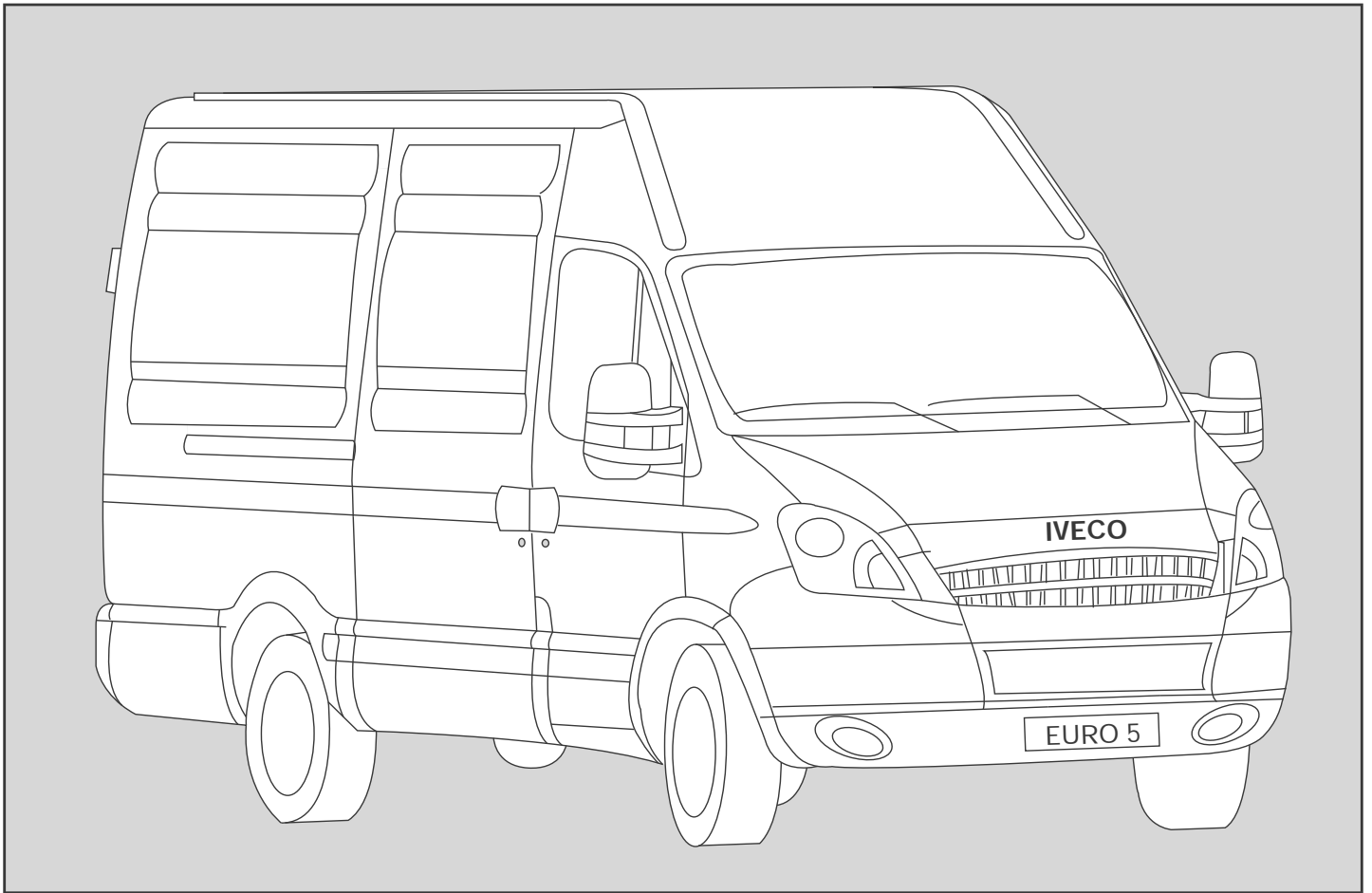

VEHICLE DETAILS

Manufacturer	Iveco
Make	Eco Daily
Model	29L11/13/15, 35S11/13/15, 35C11/13, 40C11/13
Engine CC	2286
Engine Details	Euro 5 - F1A - 106 / 126 / 146 HP
Year	10.2011 >
Chassis Nos.	-
LHD	YES
RHD	YES
PAS	YES
A/C	YES
Voltage	12v

KIT DETAILS

Kit Part No.	0500.6342
Description	Standard Kit
Compressor RPM	3900 @ Max Engine Power Output
Fitting Time	180 Minutes
Suction Fitting	45°
Discharge Fitting	45°
Belt Type	4PK 1025
Belt Part No.	0820.5531

RECOMMENDED COMPRESSORS

SELTEC	TM-13 HS	TM15-HS	TM16-HS
Comp No	0381.0412	0381.0032	0381.0512
Seltec No.	-	488.45322	488.46322
Mounting	Ear	Ear	Ear
Rotor	8PV	8PV	8PV
Armature	SL	SL	SL
Diameter	123	123	123
Voltage	12	12	12
Orientation	H	H	H
Fitting	3/4 x 7/8	3/4 x 7/8	3/4 x 7/8
Manifold	Bolt	Bolt	Bolt

QUE	QP13-HD	QP15-HD	QP16-HD
Comp No	0391.0412	0391.0032	0391.0512
QUE No.	-	QP15-1340	-
Mounting	Ear	Ear	Ear
Rotor	8PV	8PV	8PV
Armature	SL	SL	SL
Diameter	123	123	123
Voltage	12	12	12
Orientation	H	H	H
Fitting	3/4 x 7/8	3/4 x 7/8	3/4 x 7/8
Manifold	Bolt	Bolt	Bolt

SANDEN	SD5H09	SD5H14	SD7H15
Comp No	-	-	-
Sanden No.	-	-	-
Mounting	-	-	-
Rotor	-	-	-
Armature	-	-	-
Diameter	-	-	-
Voltage	-	-	-
Orientation	-	-	-
Fitting	-	-	-

Notes

COMPRESSOR KIT CONFIGURATIONS

PART NUMBER	COMPRESSOR KIT PART NOS						DESCRIPTION	QTY.
	0513.6342	0515.6342	0516.6342	0593.6342	0595.6342	0596.6342		
0381.0412	●						TM13 Ear Mount 8PV SL 123 12V H 3/4 x 7/8 Bolt	1
0381.0032		●					TM15 Ear Mount 8PV SL 123 12V H 3/4 x 7/8 Bolt	1
0381.0512			●				TM16 Ear Mount 8PV SL 123 12V H 3/4 x 7/8 Bolt	1
0391.0412				●			QP13 Ear Mount 8PV SL 123 12V H 3/4 x 7/8 Bolt	1
0391.0032					●		QP15 Ear Mount 8PV SL 123 12V H 3/4 x 7/8 Bolt	1
0391.0512						●	QP16 Ear Mount 8PV SL 123 12V H 3/4 x 7/8 Bolt	1

● = Additional parts to standard kits.

PARTS VIEW

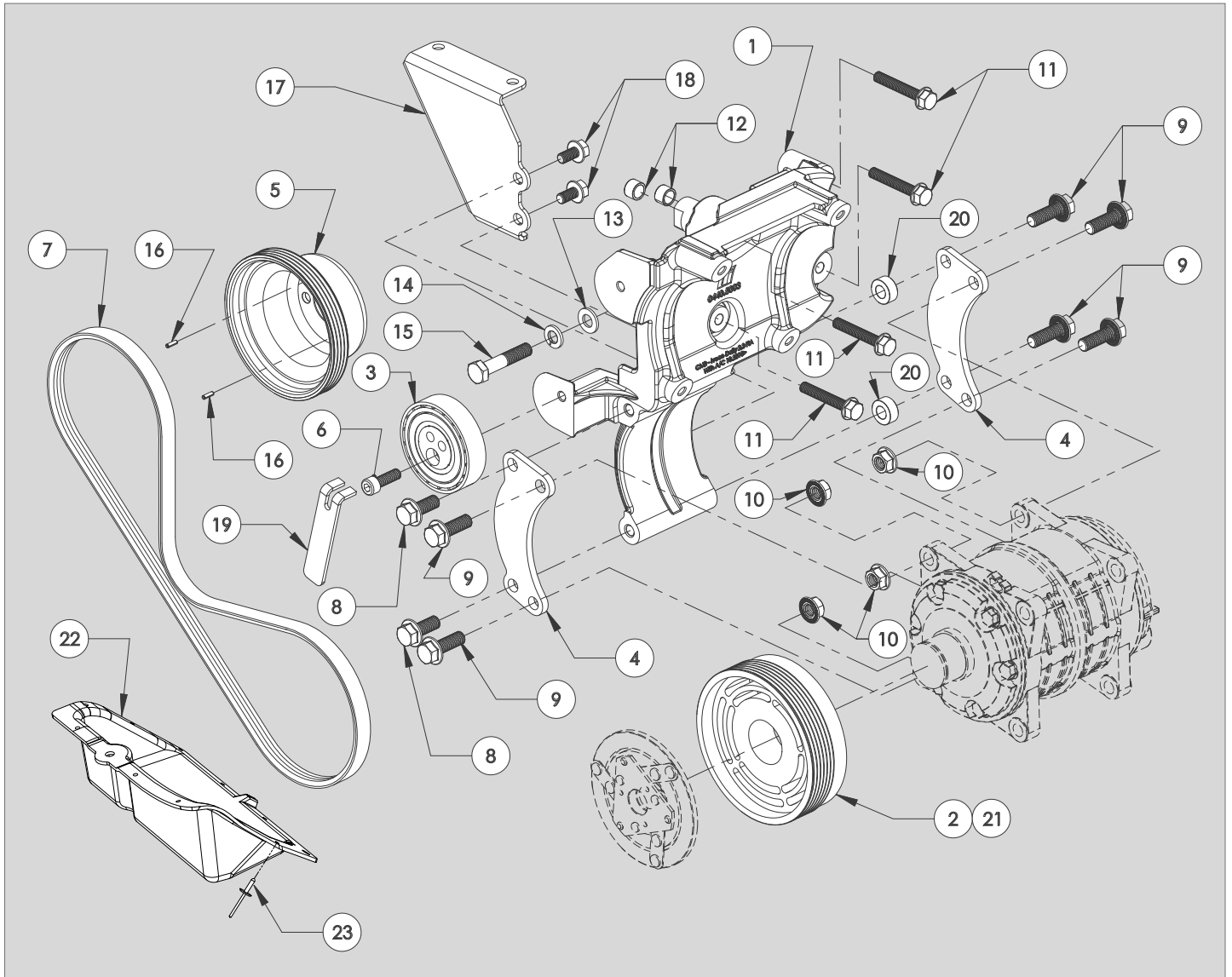

ITEM	PART NO	DESCRIPTION	QTY
1	0440.5003	Compressor Bracket	1
2	0411.5083	Special Clutch Rotor	1
3	1700.0373	Eccentric Idle Pulley	1
4	3020.8993	Compressor Mounting	2
5	1701.5083	Crankshaft Drive Pulley	1
6	2704.5371	Cap Screw M8 x 25:1.25	1
7	0820.5531	Belt 4PK 1025	1
8	2705.0801	Bolt M10 x 25 : 1.50	2
9	2705.0491	Bolt M10 x 30 : 1.50	6
10	2735.0071	Nut M10 :1.50	4
11	2704.0101	Bolt M8 x 50 : 1.25	4

ITEM	PART NO	DESCRIPTION	QTY
12	2800.0291	Dowel Bush	2
13	2809.0011	Washer M10 Flat	1
14	2809.0031	Spring washer M10	1
15	2705.0731	Bolt M10 x 50 - 1.25	1
16	2762.0091	Spring Pin - 3 x 10	2
17	3020.9293	Support Bracket	1
18	2704.1521	Bolt - M8 x 16 : 1.25	2
19	3020.3863	Pulley Adjusting Tool	1
20	2803.9013	Spacer - 20OD x 10.40	2
21	0410.5033	Clutch Ass'y - Not Incl.	1
22	2002.5231	Under panel Cover	1
23	2760.1031	Pop Rivet	10

FOREWORD

- The purpose of this manual is to facilitate the installation of a direct drive compressor. The information given is merely instructive, should any complications arise contact the Technical department. The manufacturer's warranty does not cover any problems caused by defective installation or alterations made unless authorised. The manufacturer shall not be responsible for any injury, damage or loss caused directly or indirectly as a result of using this manual or the information contained within it.

1 SAFETY MEASURES:

Before fitting the Compressor adapter drive kit, ensure the following for damage:

- Inner and outer trim and body work
- Engine idle pace
- Check all the vehicle functions

Check list:

- Ensure that the right kit has been selected
- Before installing, check that all the correct pieces are present; also ensure that there are no missing or broken pieces
- When fitting, make sure the vehicle is properly protected against damage.

Installation apparatus

- Calibrated torque wrench
- Hand service tools
- Protective covers and shields

2 PRECAUTIONS

- Detach the battery negative lead.
- Torque all bolts where stated using a calibrated torque wrench.
- Take extreme care with moving parts.
- Remove the vehicles ignition key and keep it with you.
- Wear safeguards to make sure that liquid refrigerant never touches your skin

Caution: Measures must be followed accurately to steer clear of the possibility of damage to individuals

Warning: This calls awareness to actions which must be pursued to avoid damage to the components.

NB: This calls awareness to make the job easier or gives useful information.

STANDARD FASTENER TORQUE VALUES

- In the absence of specific torque values detailed in this fitting instruction manual, the following chart can be used as a guide to the maximum safe torque for specific size and grade of fastener.

STRENGTH	4.8		8.8		10.9		12.9	
	Max Torque		Max Torque		Max Torque		Max Torque	
Dia / Pitch	lb.ft	Nm	lb.ft	Nm	lb.ft	Nm	lb.ft	Nm
M5 x 0.80	2	3	4.5	6	6.5	9	7.5	10
M6 x 1.00	4	5.5	7.5	10	11	15	13	18
M8 x 1.25	10	13	18	25	26	35	33	45
M10 x 1.25	20	27	39	53	57	78	66	90
M10 x 1.50	18	25	37	50	55	73	63	86
M12 x 1.75	33	45	63	85	97	130	111	150
M14 x 2.00	55	75	103	140	151	205	177	240
M16 x 2.00	85	115	159	215	232	315	273	370

PRE-INSTALLATION

1. Remove and retain the engine under panel.
2. Remove and retain the original stretch-belt **A** fitted to the air conditioning compressor **D** - Fig 1
3. Remove and retain the original auxiliary drive belt **B** - Fig 1
4. Remove and retain the 4 x original crankshaft pulley bolts and the crankshaft pulley **C** - Fig 1
5. Remove the air conditioning compressor **D** and retain securing bolts - Fig 1.
6. Remove and discard the air conditioning compressor mount bracket **E** - Fig 1
7. Remove and retain the 2 x sump bolts **F** - Fig 1

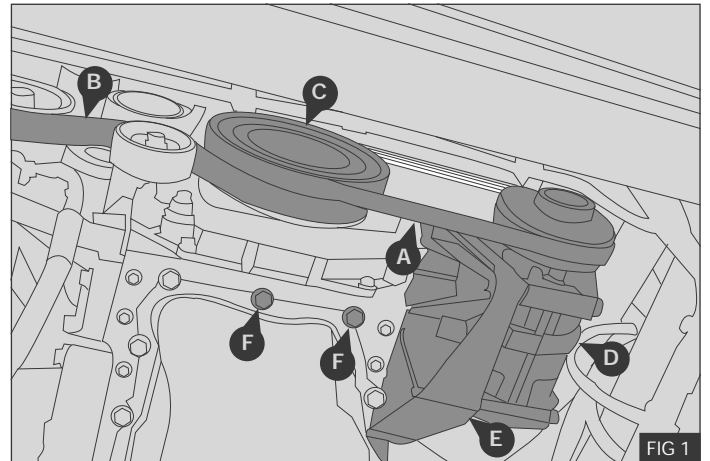

CRANKSHAFT PULLEY INSTALLATION

1. Temporarily place the supplied pulley **5** into the position shown - Fig 2
2. Insert the supplied 3mm roll pins **16** into the holes in the original crankshaft pulley **C** - Fig 4
3. Fit the original crankshaft pulley **C** onto the crankshaft and mount the supplied pulley **4** onto the roll pins **16** in the original pulley **C** - Fig 3

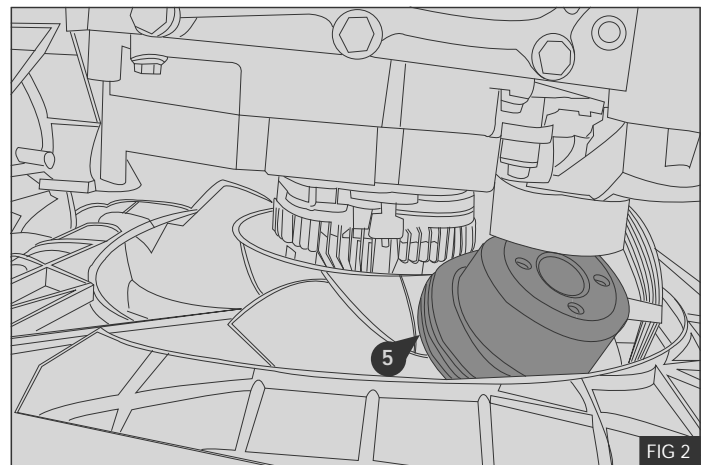

Caution: Take care not to damage the fan blades when fitting the crankshaft pulley.

4. Refit the 4 x crankshaft pulley bolts **H** previously removed and torque to 30 Nm
Refit the original auxiliary drive belt **B**

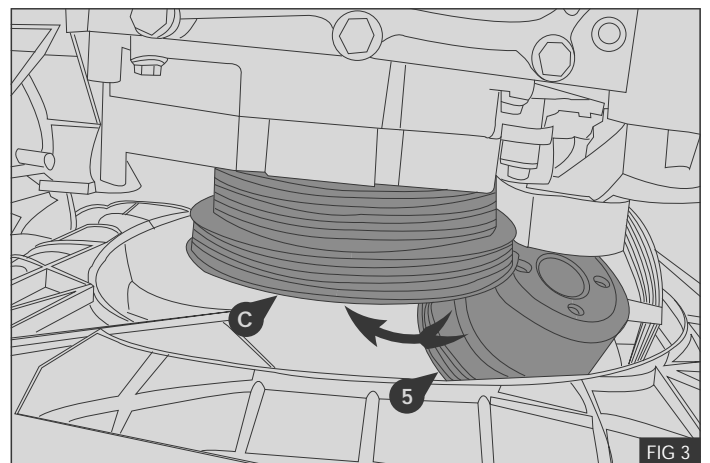

NB: Please refrain from using "Loctite" unless otherwise notified.

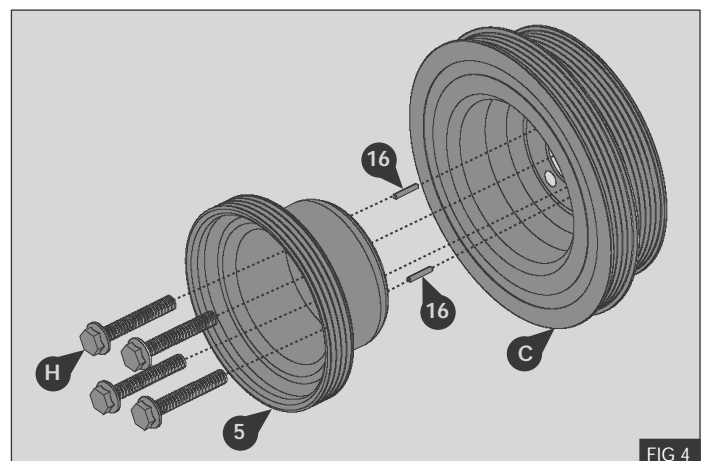

MOUNT BRACKET INSTALLATION

1. Secure the compressor mount bracket (1) to the engine using 4 x M8 x 50 bolts (11) and 1 x M10 x 50 bolt (15) with spring washer (13) and flat washer (14) - Fig 5
2. Hand tighten bolts (11) and (15) then Torque in the following sequence :
 - a Torque M10 x 50 bolt (15) to 53Nm
 - b Torque M8 x 50 bolts (11) to 35Nm
3. Fit the supplied support bracket (17) to the mount bracket (1) with bolts (18) and original sump bolts (F) then Torque bolts in the following sequence :
 - a Torque bolts (F) to 35Nm
 - a Torque bolts (18) to 35Nm
4. Secure the original air conditioning compressor (D) to the mount bracket (1) using the original bolts (I) - Fig 6
5. Torque bolts (I) to 22Nm
6. Loosely fit the idle pulley (3) to the mount bracket (1) with bolt (6) - Fig 6
7. Refit the original stretch air conditioning drive belt (A) to the compressor and the crank pulley using a suitable tool (Not supplied) - Fig 7

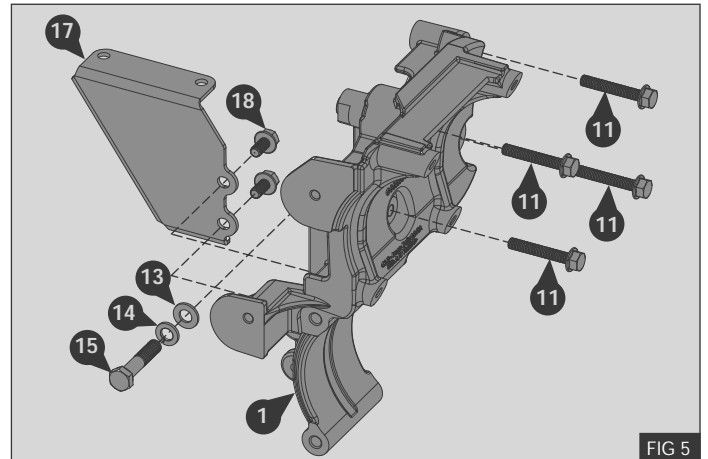

FIG 5

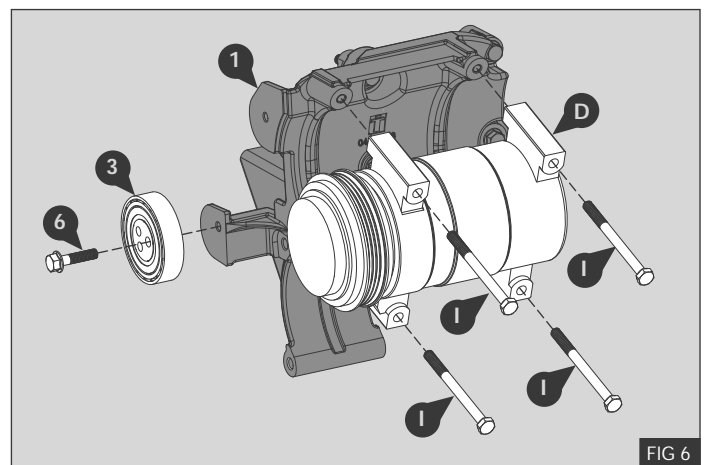

FIG 6

COMPRESSOR MODIFICATION

1. Remove the shaded area, shown in Detail A from the compressor (J) - Fig 7
2. Install the supplied compressor clutch rotor (2) to the compressor (J) - Fig 7

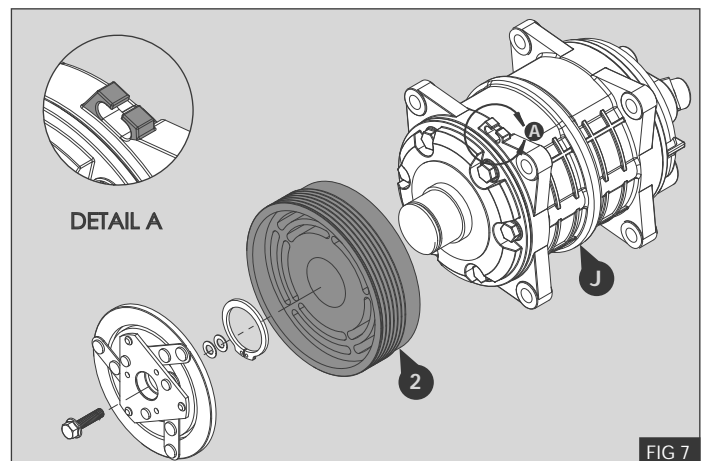

FIG 7

COMPRESSOR INSTALLATION.

1. Secure the compressor (J) to the mount bracket supports (4) using 4 x M10 x 30 bolts (9) and nuts (10) - Fig 8
2. Torque M10 x 30 bolts (9) to 50Nm

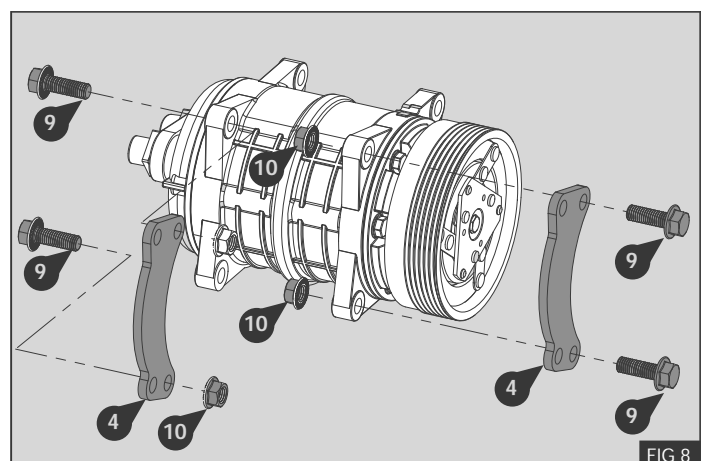

FIG 8

1. Secure the compressor (J) to the mount bracket (1) using 2 x M10 x 25 bolts (8) in the front position and 2 x M10 x 30 bolts (9) with spacers (20) at the rear - Fig 9
2. Torque bolts (8) and (9) to 50Nm

DRIVE BELT

1. Fit the compressor drive belt (7) as shown in - Fig 10

NB: Where applicable and dependent on the compressor model, align the supplied drive belt by installing in the correct clutch groove - Fig.11

2. Tension the drive belt to correct tension (see table) using the supplied eccentric tool (10), tighten bolt (6) to lock eccentric pulley (3) - Fig 10
3. Torque bolt (6) to 25 Nm

BELT TENSION TABLE		
Belt	Belt Age	Belt Tension using a Belt Tension Gauge
4 PK	New Belt	48 - 56 kg
4 PK	Used Belt / Re-Tension	36 - 40 kg

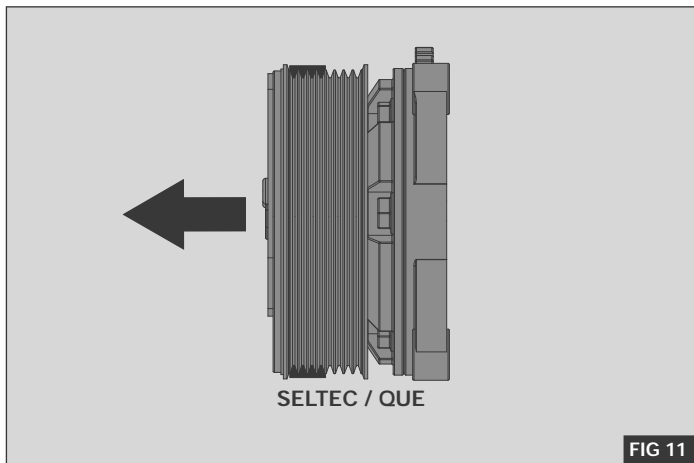
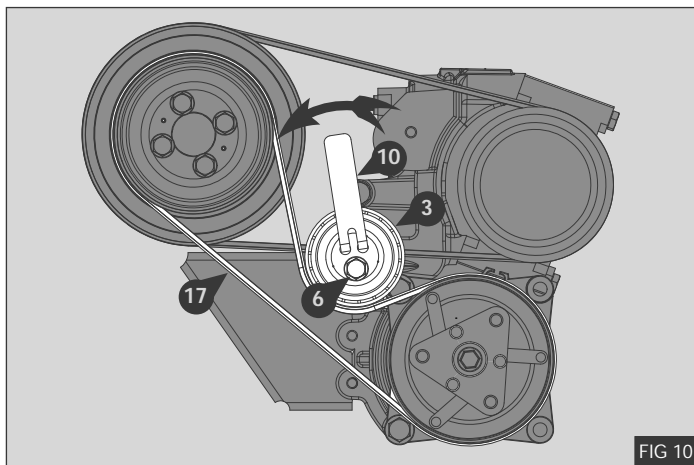
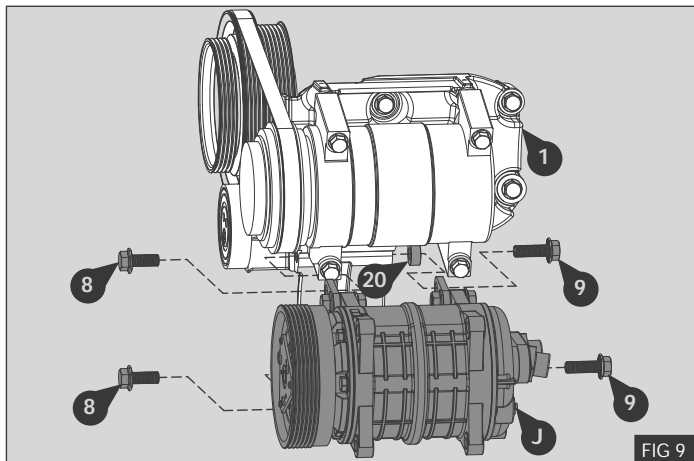

UNDER PANEL INSTALLATION

1. Using under panel pod and dimensions as a guide modify the under-panel as shown - Fig 12

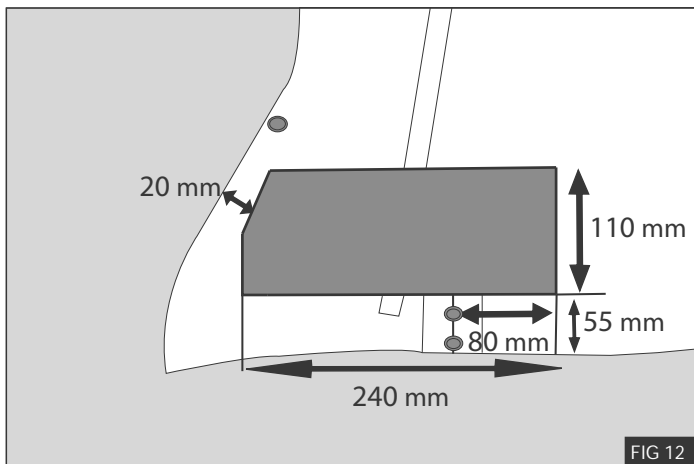

2. Drill 10 x 4 mm holes corresponding to the under-panel pod (22) and secure using 10 x pop rivets (23).

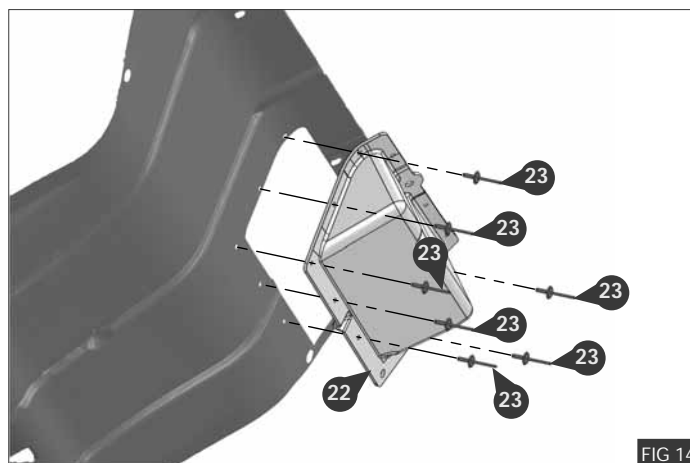

FINISH

1. Before starting the engine check all the installed parts and ensure that the belt is installed correctly. Run the unit for at least ten minutes, then check the whole mounting assembly and previously removed parts. Attach the supplied warning label on to a suitable location.

Note: Check the belt tension when the belt is hot. IT IS IMPORTANT THAT THE BELT IS ALLOWED TO COOL BEFORE RE-TENSIONING. Always re-tension NEW belts if the tension is less than the USED BELT AMOUNT.

2. Install modified under panel using original fasteners.

